



# 200 Series Regulators

## 206 Series Regulator

Single Stage

Chrome-Plated Forged Brass Body

316L Stainless Steel Diaphragm

Liquid Cylinder Regulator

Four Port Configuration

The 206 Series regulators are intended for primary pressure control of gases supplied from cryogenic liquid cylinders.



206-3021 shown

### Advanced Features

- Designed for low inlet pressures  
Optimized flow with liquid cylinders
- Large Capsule® seat  
Permits flow rates unobtainable with conventional regulators
- 3000 PSIG inlet pressure rating  
Safe use on high pressure cylinders

### Typical Applications

- Argon
- Nitrogen
- Oxygen
- Carbon Dioxide
- Certain Freons

### 200 Series Advantage

- Capsule® seat  
Increased serviceability and life
- 316L stainless steel diaphragm  
No inboard diffusion
- Forged body  
Durable, long-lasting construction
- Field-adjustable pressure limit  
Safeguard downstream equipment
- Large convoluted diaphragm  
Smooth pressure changes
- Standard relief valve  
Diaphragm and gauge protection

### Materials

- Body  
Chrome-plated forged brass
- Bonnet  
Chrome-plated die cast zinc
- Seat  
PTFE
- Filter  
10 micron sintered bronze
- Diaphragm  
316L stainless steel
- Internal Seals  
PTFE

### Specifications

- Maximum Inlet Pressure  
3000 PSIG (210 BAR)
- Temperature Range  
-40°F to 140°F (-40°C to 60°C)
- Gauge  
2½" diameter chrome-plated brass
- Ports  
¼" FPT
- Helium Leak Integrity  
1 x 10<sup>-8</sup> scc/sec
- Cv  
0.28
- Weight (206-3031-580)  
3.5 lbs. (1.59 kg)

# 200 Series Regulators

## Technical Information

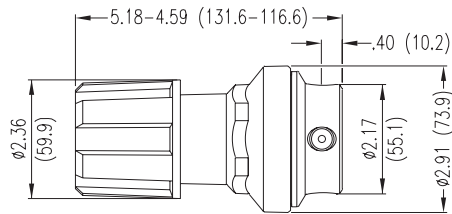
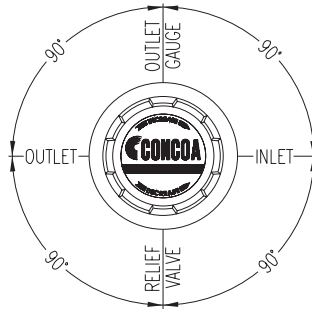
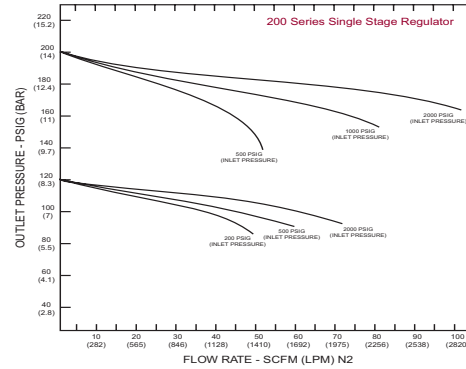
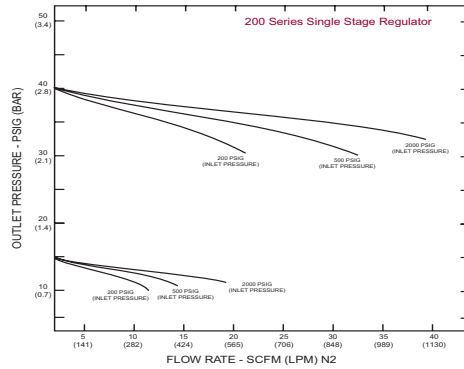

## Ordering Information

206	A	B	C	D	-Inlet	Options	
Series 206	Outlet Pressure	Outlet Gauge	Inlet Gauge	Outlet Assemblies	Assembly Gauges	Inlet Connections	Installed Options
	1: 0-15	0-30 PSIG	0: None	0: ¼" FPT Port	0: Bare Body	000: ¼" FPT	A: Protocol Alarm Station (110V)
	2: 0-40	0-60 PSIG		1: ¼" MPT	1: Standard Assembly (PSIG/kPa Gauges)	TF2: ½" Tube	B: Protocol Alarm Station (220V)
	3: 0-120	0-200 PSIG		2: ¼" Tube Fitting	2: Standard Assembly (BAR/PSIG Gauges)	TF4: ¼" Tube	C: Protocol Switchover Station
	4: 0-200	0-400 PSIG		3: Diaphragm Valve ¼" Tube Fitting		TF6: ¾" Tube	G: Protocol Switchover Station with Alarm (110V)
				4: Diaphragm Valve ¼" MPT		M06: 6mm Tube	H: Protocol Switchover Station with Alarm (220V)
				5: Needle Valve ¼" MPT		CGA	M: Protocol Station
				6: ⅛" Tube Fitting		DIN 477	Q: Protocol Purge Station
				7: ⅜" Tube Fitting		BS 341	
				8: Diaphragm Valve ⅛" Tube Fitting		and others available	
				9: Diaphragm Valve ¼" FPT			
				A: ⅜" BSP Right Hand Fitting			
				B: Diaphragm Valve ⅜" Tube Fitting			
				C: ⅜" BSP Left Hand Fitting			
				D: 6mm Brass Hose Barb (not available if A=4 or 5)			
				G: ⅛" Stainless Steel Tube Fitting			
				H: ¼" Stainless Steel Tube Fitting			
				M: 6mm Tube Fitting			
				S: Diaphragm Valve 6mm Tube Fitting			