



200 Series Regulators

205 Series Regulator

Single Stage

Chrome-Plated
Forged Brass Body

Four-Port
Configuration

316L Stainless Steel Diaphragm

The 205 Series regulators are intended for secondary pressure control of non-corrosive, high purity or liquefied gases (up to grade 4.5) or as point of use pressure control in high purity gas distribution systems.

Advanced Features

- Chrome-plated forged brass body
Economical high purity design
- High flow capacity
Supply multiple user locations
- Pressure ranges 0-15 to 0-200 PSIG
Broad range of applications
- 3000 PSIG inlet pressure rating
Safe use with high pressure cylinders

Typical Applications

- Point of use laboratory systems
- Gas supply purging
- Liquefied hydrocarbon gas control
- Control of cryogenic gases
- Bulk gas distribution systems



205-3021 shown

200 Series Advantage

- Capsule® seat
Increased serviceability and life
- 316L stainless steel diaphragm
No inboard diffusion
- Forged body
Durable, long-lasting construction
- Field-adjustable pressure limit
Safeguard downstream equipment
- Large convoluted diaphragm
Smooth pressure changes
- Standard relief valve
Diaphragm and gauge protection

Materials

- Body
Chrome-plated forged brass
- Bonnet
Chrome-plated die cast zinc
- Seat
PTFE
- Filter
10 micron sintered bronze
- Diaphragm
316L stainless steel
- Internal Seals
PTFE

Specifications

- Maximum Inlet Pressure
3000 PSIG (210 BAR)
- Temperature Range
-40°F to 140°F (-40°C to 60°C)
- Gauge
2½" diameter chrome-plated brass
- Ports
¼" FPT
- Helium Leak Integrity
1 x 10⁻⁸ scc/sec
- Cv
0.28
- Weight (205-3031-TF4)
3.2 lbs. (1.44 kg)

200 Series Regulators

Technical Information

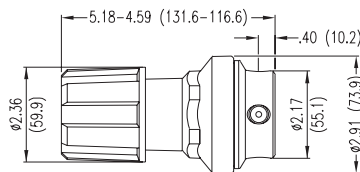
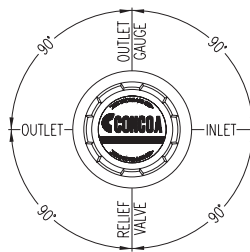
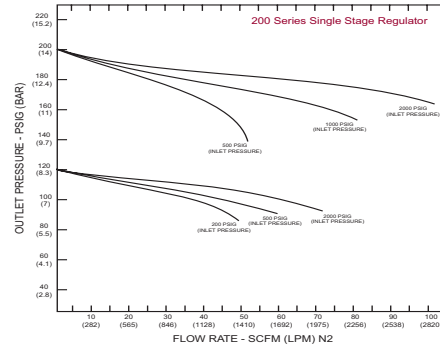
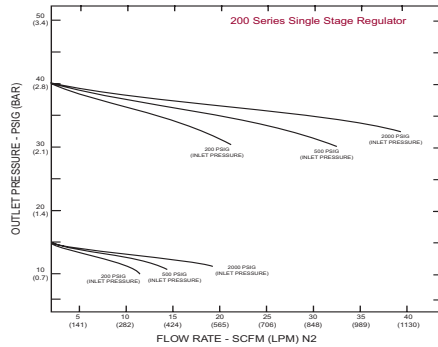

Ordering Information

205	A	B	C	D	-Inlet	Options	
Series 205	Outlet Pressure	Outlet Gauge	Inlet Gauge	Outlet Assemblies	Assembly Gauges	Inlet Connections	Installed Options
	1: 0-15	0-30 PSIG	0: None	0: ¼" FPT Port	0: Bare Body	000: ¼" FPT	M: Protocol Station
	2: 0-40	0-60 PSIG		1: ¼" MPT	1: Standard Assembly (PSIG/kPa Gauges)	TF2: ⅛" Tube	Q: Protocol Purge Station
	3: 0-120	0-200 PSIG		2: ¼" Tube Fitting	2: Standard Assembly (BAR/PSIG Gauges)	TF4: ¼" Tube	
	4: 0-200	0-400 PSIG		3: Diaphragm Valve ¼" Tube Fitting	6: Mirror Image Assembly (PSIG/kPa Gauges)	TF6: ⅜" Tube	
	5: 0-15*	0-30 PSIG		4: Diaphragm Valve ¼" MPT	7: Mirror Image Assembly (BAR/PSIG Gauges)	M06: 6mm Tube	
	*With redline for acetylene use			5: Needle Valve ¼" MPT		CGA	
				6: ⅛" Tube Fitting		DIN 477	
				7: ⅜" Tube Fitting		BS 341	
				8: Diaphragm Valve ⅛" Tube Fitting		and others available	
				9: Diaphragm Valve ¼" FPT			
				A: ⅜" BSP Right Hand Fitting			
				B: Diaphragm Valve ⅜" Tube Fitting			
				C: ⅜" BSP Left Hand Fitting			
				D: 6mm Brass Hose Barb (not available if A=4 or 5)			
				G: ⅛" Stainless Steel Tube Fitting			
				H: ¼" Stainless Steel Tube Fitting			
				M: 6mm Tube Fitting			
				S: Diaphragm Valve 6mm Tube Fitting			

200 Series